

City of Casa Grande, Development Center, 510 East Florence Blvd., Casa Grande, Arizona 85122

Site Plan Review for New Manufactured Buildings and Mobile Homes

Park/Project Name: _____

Street Address: _____ Space No.: _____

Unit Owner: _____

Street Address: _____

City: _____ State: _____ Zip: _____ Phone No: _____

Applicant & Contact Person: _____

Street Address: _____

City: _____ State: _____ Zip: _____ Phone No: _____

Email: _____

Unit Information

Manufacturer: _____ Year: _____ Model: _____

Serial #: _____ Unit Identification #: _____

Size(dimensions): _____ Cost of Installation(Construction): _____

Installer/Contractor: _____

Street Address: _____

City: _____ State: _____ Zip: _____ Phone No: _____

Email: _____

APPLICATION SUBMITTAL REQUIREMENTS

Provide 2 copies of proposed site plan.

This check list is to help you assure that all site plan items needed for zoning review are being submitted at this time.

(see attached sample site plan)

Site Plan drawn to scale (i.e., 1 " = 20 ft. or similar)

Dimensions of the lot/site:

Location, dimensions and height of manufactured building or mobile home:

Location, dimensions, and height of any attached or detached accessory structures: Setback dimensions for all structures from all lot/site boundaries

Location and dimensions for all on-site parking

Statement of contractor/applicant made in connection with application for permit, pursuant to A.R.S. 32-1169.A

Owner Occupant of a Residential Property

Contractor is currently licensed pursuant to the provisions of Arizona Revised Statutes, Title 32, Chapter 10

ROC license number : _____

Privelege license number: _____ (pursuant A.R.S. 42-5005)

Applicant is not a licensed contractor and is exempt from the provisions of Arizona Revised Statutes, Title 32 Chapter 10, A.R.S. 32-1121. Provide basis exemption, name, and license number of contractors who will be performing work on a seperate form

I hereby certify that I have read and examined this application and know the same to be true and correct. All provisions of laws and ordinances governing this type of work will be complied with whether specified herein or not.

Owner/Representative Signature

Print Name

Date

This permit constitutes Site Plan Approval for the above described unit in the location given. It does not guarantee approval of said installation. It does not guarantee a permit from the Office of Manufactured Housing. Any questions on State requirements for permitting call the Office of Manufactured Housing at 602-364-1003.

APPLICATION IS VALID FOR 180 DAYS AFTER SUBMITTAL DATE

PARK/PROJECT NAME: PALM CREEK

PROPERTY ADDRESS: 1100 N HENNESS RD SPACE/LOT NO.: 135

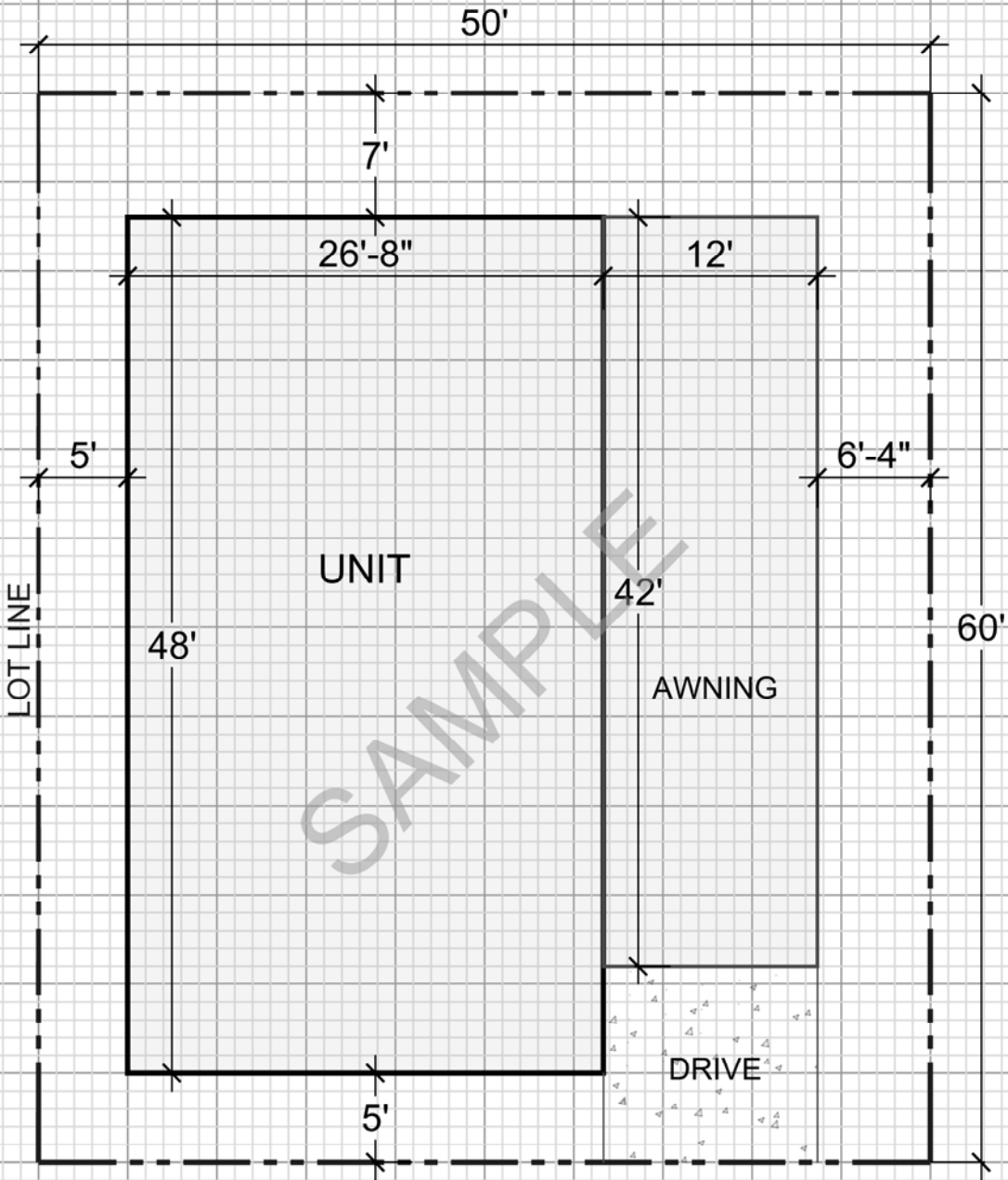

SCALE: 1" = 10'
DATE: 04/08/15

PARK/PROJECT NAME: _____

PROPERTY ADDRESS: _____ SPACE/LOT NO.: _____

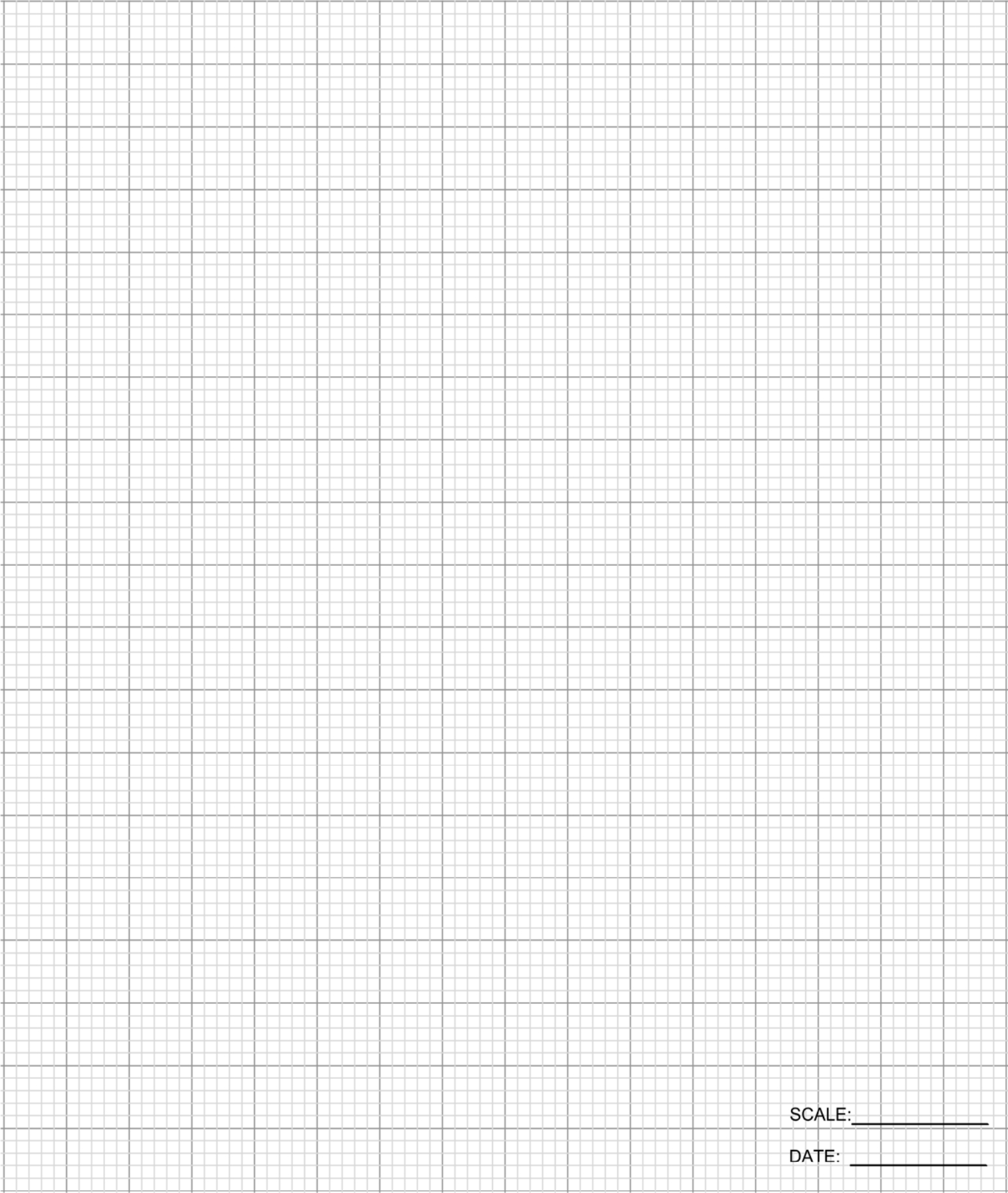

SCALE: _____

DATE: _____